

# Clean Bench

**HCB-900V HCB-1300H**  
**HCB-1300V HCB-1600H**



## Main Applications

A professional localized air purification equipment suitable for pharmaceuticals, medical and health, scientific research laboratories of universities and colleges, photoelectric/microelectronics manufacturing and other fields

**Qingdao Haier Biomedical Co.,Ltd.**

No.280 Feng Yuan Road, High-tech Zone,  
Qingdao, 266109, P.R. China  
Tel: +86-0532-88935593  
Website: [www.haiermedical.com](http://www.haiermedical.com)



Haier Biomedical  
International



Haier Biomedical  
International



@haiermedicalint



@haierbiomedicalint



Haier Biomedical  
International

## Product advantages

- Manufactured with an internationally branded moisture-proof and flame-retardant glass fiber high efficiency particulate air filters (HEPA), which ensures a filtration efficiency of 99.99% or above for particles of 0.3um or above
- The air cleanliness conforms to Class 5 of the ISO14644.1 Standard, and is better than Class 100 cleanliness requirements
- With the industry's first pre-cleaning function: namely pre-cleaning the workspace before sample treatment so as to further improve the protection of samples
- Adopting built-in lighting to prevent the eyes from being exposed to the fluorescent lamp and thus avoids eye strain

### One-key operation, convenient and secure:

- With a timed UV lamp turnoff function, it is adjustable between 0 and 99 minutes
- Interlock function, avoiding the risk of mis-operation
- With the lighting lamp and UV lamp interlock function; the UV lamp can only be lit when the lighting lamp is off. After the fluorescent lamp turned on, the UV lamp will be turned off immediately so that the risk of mis-operation can be reduced to zero

## Friendly design

### Ergonomic design, making work easier

- The table top is 800mm high from the ground, which is suitable for both standing and sitting operations, relieving any fatigue issues and makes work easy

### Delay start of UV sterilization to avoid UV damage

- After the UV lamp switch is pressed down, there will be sound and light signals to remind the operators to leave immediately and the UV lamp will light up after a delay of 10 seconds to protect the operator from ultraviolet radiation
- The UV sterilization timed start function ensures less down time of usage and higher efficiencies from the user

### Split type chassis for easy installation and movement

- With separated chassis, cabinet body and universal casters with adjustable feet for easy movement and fixation

## Product dimensions

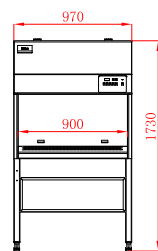

HCB-900V

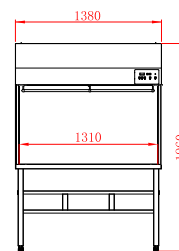
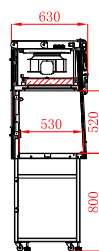

HCB-1300H

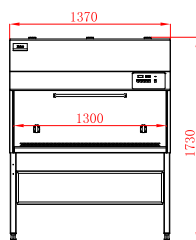
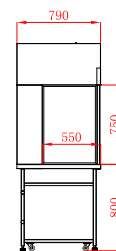

HCB-1300V

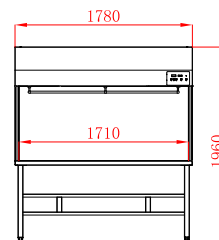
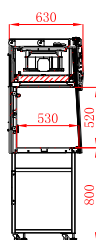

HCB-1600H

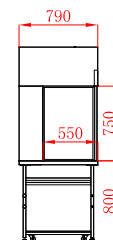

## Specifications

Model		HCB-900V	HCB-1300V		HCB-1300H			HCB-1600H	
Flow Type		Vertical	Vertical		Horizontal			Horizontal	
Voltage/Frequency(V/Hz)		AC 220/50	AC 220/50	AC 115V/60	AC 220/50	AC 220/60	AC 115V/60	AC 220/50	AC 220/60
Power(W)		1200	1200		350			350	
Vibration Amplitude (UM)		2	2		2			2	
Exhaust Filter Typical Efficiency		H13 HEPA, 99.99%@0.3um	H13 HEPA, 99.99%@0.3um		H13 HEPA, 99.99%@0.3um			H13 HEPA, 99.99%@0.3um	
Average Velocity (M/S)		0.2-0.4	0.2-0.4		0.2-0.4			0.2-0.4	
Fluorescent Lamp Intensity(Lux)		≥300	≥300		≥1000			≥1000	
Net/Gross Weight (approx.)	kg	115/145	145/171		145/175			165/214	
	lbs	254/319	320/376		319/385			363.7/471	
Sound Level(dB(A))		58	58		61			61	
Internal Dimensions (W*D*H)	mm	900*530*520	1300*530*520		1310*550*750			1710*550*750	
	in	35.4*20.9*20.5	51.2*20.9*20.5		51.6*21.7*29.6			67.3*21.7*29.6	
External Dimensions (W*D*H)	mm	970*630*1730	1370*630*1730		1380*790*1960			1780*790*1960	
	in	38.2*24.8*68.1	53.9*24.8*68.1		54.4*31.1*77.2			70.1*31.1*77.2	
Packing Dimensions (W*D*H)	mm	1105*745*1280	1505*745*1280		1465*940*1350			1865*940*1370	
	in	43.5*29.3*50.4	59.3*29.3*50.4		57.7*37*53.2			73.4*37.0*53.9	
Cleanliness Classification		ISO 14644.1 Class 5	ISO 14644.1 Class 5		ISO 14644.1 Class 5			ISO 14644.1 Class 5	
Container Load(20'/40'/40'H)		15/33/33	10/25/25		8/16/16			6/12/12	
Certification		CE,TUV,NMPA(CFDA)	CE,TUV,NMPA(CFDA)		CE,TUV			CE,TUV,NMPA(CFDA)	